

# TALA OFFSHORE AS

## STAINLESS BLIND FLANGES 600 LBS

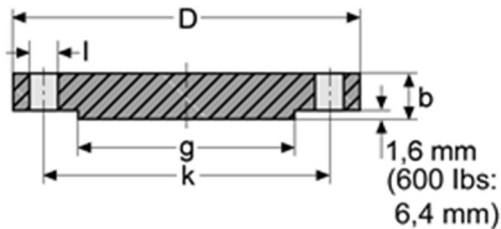

ASTM A182, ASME B16.5

Raised face, smooth finish (125-250 RMS / 3.2-6.3  $\mu\text{m}$ )

Pipe		Flange		Raised face	Drilling template		Weight	
Nom. size	O.D. Pipe	D	b	g	l	K	No. Of holes	Kg/pc
In.	mm	mm	mm	mm	mm	mm		
1/2"	21.3	95.3	14.2	35.1	15.7	66.5	4	0.700
3/4"	26.7	117.3	15.7	42.9	19.1	82.5	4	1.200
1"	33.4	124	17.5	50.8	19.1	88.9	4	1.600
1 1/2"	48.3	155.4	22.4	73.2	19.1	114.3	4	3.250
2"	60.3	165.1	25.4	91.9	22.4	127	8	4.150
3"	88.9	209.6	31.8	127	22.4	168.1	8	8.440
4"	114.3	273.1	38.1	157.2	25.4	215.9	8	17.30
6"	168.3	355.6	47.8	215.9	28.4	292.1	12	36.10

Standard specification for ASTM flanges

Flanges, forged, ASTM A 182, F304/304L or F316/316L (dual marked and certified), ASME B16.5, annealed and fully machined, raised face, smooth finish (125-250 RMS / 3.2-6.3 $\mu\text{m}$ ) to MSS-SP6, hardness to NACE MR0175 latest edition. IC checked to ASTM A262 E and PMI tested

All ASTM/ASME flanges are certified according to EN 10204/3.1.