

TALA OFFSHORE AS

STAINLESS BLIND FLANGES 300 LBS

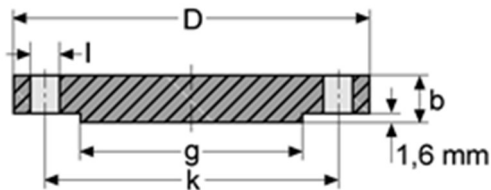

ASTM A182, ASME B16.5

Raised face, smooth finish (125-250 RMS / 3.2-6.3 μm)

Pipe		Flange		Raised face	Drilling template		Weight	
Nom. size	O.D.	D	b	g	l	K	No. Of holes	Kg/pc
In.	mm	mm	mm	mm	mm	mm		
1/2"	21.3	95.2	14.2	35	15.7	66.5	4	0.640
3/4"	26.7	117.3	15.7	42.9	19	82.5	4	1.110
1"	33.4	123.9	17.5	50.8	19	88.9	4	1.390
1 1/4"	42.2	133.3	19	63.5	19	98.5	4	2.000
1 1/2"	48.3	155.4	20.6	73.1	19	114.3	4	2.660
2"	60.3	165.1	22.3	91.9	22.3	127	8	3.180
2 1/2"	73	190.5	25.4	104.6	22.3	149.3	8	5.100
3"	88.9	209.5	28.4	127	22.3	168.1	8	6.810
4"	114.3	254	31.7	157.2	22.3	200.1	8	11.50
5"	141.3	279.4	35.1	185.7	22.3	235	8	15.50
6"	168.3	317.5	36.5	215.9	22.3	269.7	12	20.90
8"	219.1	381	41.1	269.7	25.4	330.2	12	34.30
12"	323.8	444.5	47.6	323.8	28.6	387.3	16	57.00
14"	355.6	520.7	50.8	381	31.7	450.8	16	82.00

Standard specification for ASTM flanges

Flanges, forged, ASTM A 182, F304/304L or F316/316L (dual marked and certified), ASME B16.5, annealed and fully machined, raised face, smooth finish (125-250 RMS / 3.2-6.3 μm) to MSS-SP6, hardness to NACE MR0175 latest edition. IC checked to ASTM A262 E and PMI tested

All ASTM/ASME flanges are certified according to EN 10204/3.1.